

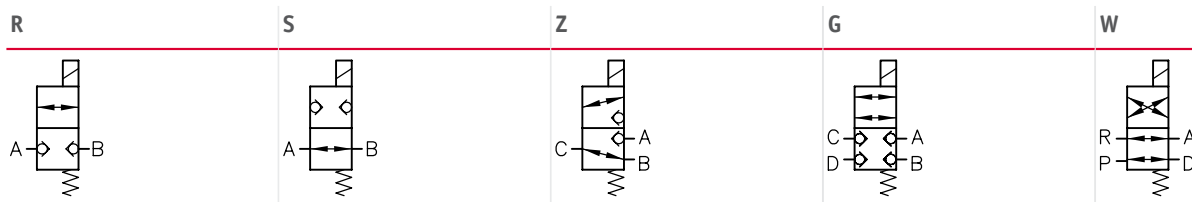

## Function



## General parameters and dimensions

Individual valve  
Example: VP1R-G24

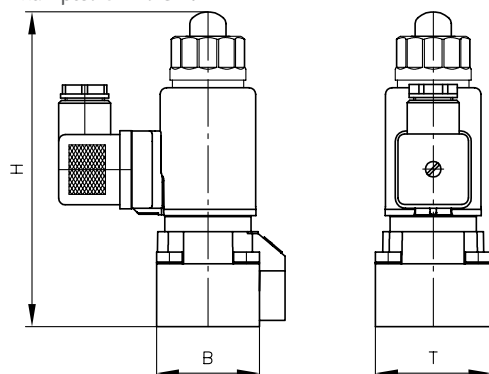

Valve with sub-plate  
Example: VP1W-3/4-WG 230

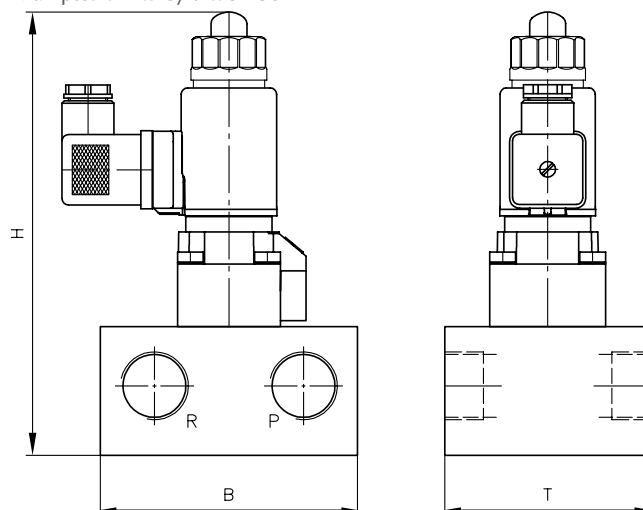

	$Q_{\max}$ [lpm]	$p_{\max}$ [bar]	Ports (BSPP)	Dimensions [mm]			$m_{\max}$ [kg]
			A, B, C	$H_{\max}$	$B_{\max}$	$T_{\max}$	
VP 1	15	400	G 1/4, G 3/8, G 3/4	127	40	50	1.0
VP 1 with sub-plate				147 ... 177	50 ... 100	45 ... 80	1.5 ... 2.2

-  $H_{\max}$ : Figures apply to solenoid actuation

### Associated technical data sheets:

- Directional seated valves type VP: [D 7915](#)

### Similar products:

- Directional seated valves type BVG1, BVP1, BVE, NBVP16:  
[D 7400](#), [D 7921](#), [D 7765 N](#)

### Plugs:

- With LEDs or  
to support the EMV etc.: [D 7163](#)
- With economy circuit: [D 7813](#), [D 7833](#)