

Accessories with integrated function

Line flow control

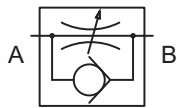

Version	Symbol	Type
Flow control unidirectional		V10

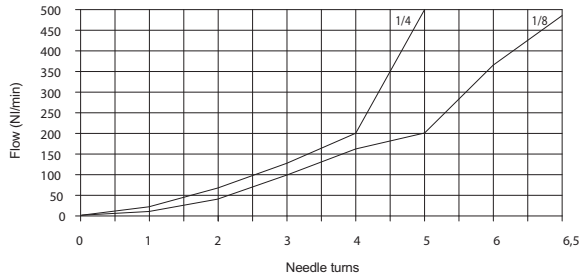

Adjusting by rotate the gear on main body, flow direction from hexagone to round end.

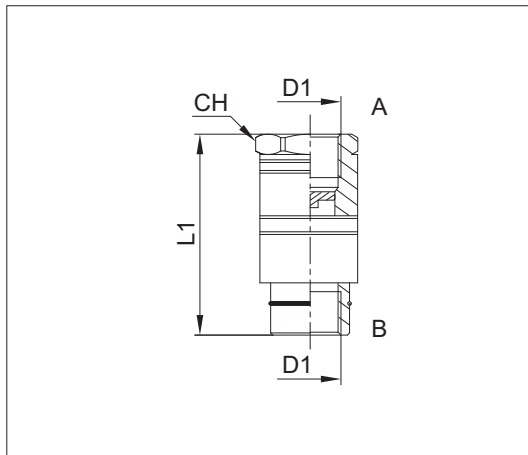

Code	Item	D ₁	L ₁	Ch
024012	V100018	1/8"	39,5	15
024013	V100014	1/4"	52	19

Technical data	
Fluid	Compressed air
Pressure range	0 + 10 bar
Temperature range	-20 °C + + 70°C
Parallel threads	UNI - ISO 228 / 1 (BSP)
Materials	Body: Nickel plated brass Spring: Stainless steel AISI 302 Sfera: POM Seals: Nitrile rubber (NBR)