

Mechanically operated valves \varnothing 4 and 1/8"

\varnothing 4, 3/2 normally open and normally closed

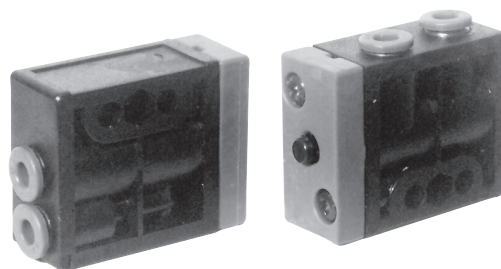

Executions			
Version	Symbol	Code	Item
3/2, with plunger, N.O.		032291	AC104132A
3/2, with plunger, N.C.		032292	AC104132C
3/2, with plunger, N.O., with side connections		032293	AC104132AL
3/2, with plunger, N.C., with side connections		032294	AC104132CL
3/2, with bi-directional lever and roller, N.O.		032295	AC204132A
3/2, with bi-directional lever and roller, N.C.		032296	AC204132C
3/2, with bi-directional lever and roller, N.O., with side connections		032297	AC204132AL
3/2, with bi-directional lever and roller, N.C., with side connections		032298	AC204132CL
3/2, with uni-directional lever, N.O.		032299	AC304132A
3/2, with uni-directional lever, N.C.		032303	AC304132C
3/2, with uni-directional lever, N.O., with side connections		032301	AC304132AL
3/2, with uni-directional lever, N.C., with side connections		032302	AC304132CL



Series of poppet microvalves mechanically operated. Connections with integral 4 mm push-in fittings. According to the application you can choose between the version with bottom connections or side ones.

2

Technical data	
Fluid	Compressed filtered air with or without lubrication. Lubrication, if be used, must be continous.
Pressure range	0 ÷ 8 bar
Temperature range	-20 °C ÷ + 80°C
Operating force	5 N
Flow	80 NI/min
Connections	With integral 4 mm push-in fittings
Fixing	Through 4 mm holes on the body
Mounting	In any position
Materials	Body: Acetal resin Seals: Nitrile rubber (NBR)

Mechanically operated valves $\varnothing 4$ and $1/8''$
 $\varnothing 4$, $3/2$ normally open and normally closed



type: **AC104132A**
AC104132C

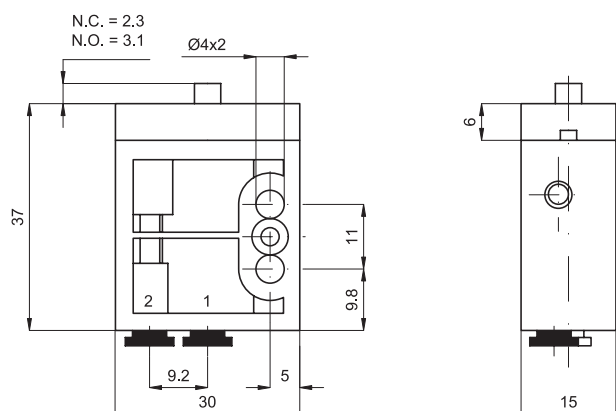

type: **AC104132AL**
AC104132CL

