

Type PLVC programmable logic valve control

The type PLVC programmable logic valve control is intended for the actuation of complex hydraulic systems. Any movement sequences with pressure, speed and acceleration profiles can be implemented and saved in pre-defined limit areas. Analogue and digital components as well as components linked to CAN bus (e.g. valves, pressure sensors, joystick) can be used via cable or remotely to control tasks. This type of control can also be described as PLC with integrated prop. amplifiers.

High flexibility via:

- Modular systems with extension and enhancement modules (Basic and expansion module)
- Flexible programming
- Different interfaces (RS 232, CAN bus, Profibus)
- All output parameters can be customised
- Software function modules (PLC programs)

Intended applications:

- Construction machinery
- Crane systems
- Complex lifting devices
- Machines for forestry purposes
- Machine tools and press construction



Nomenclature:	Programmable logic valve control
Version:	Modular concept with <ul style="list-style-type: none"> ■ Basic modules ■ Expansion modules ■ CAN bus nodes ■ Display ■ Software

Basic types and general parameters

	PLVC 41	PLVC 21	PLVC 8	CAN-IO 14
Number of inputs ¹⁾				
Digital	27 (3 / 24)	13 (5 / 8)	17 (10 / 7)	1
Analogue	28 (4 / 24)	12 (4 / 8)	23 (11 / 12)	6 (10)
Frequency	3 (3 / -)	3 (3 / -)	3 (3 / -)	-
Emergency stop	x	x	x	-
Number of outputs ¹⁾				
Digital	16 (- / 16)	16 (8 / 8)	13 (- / 13)	4
Analogue (PWM)	16 (4 / 16)	4 (4 / -)	16 (16 / -)	4
Analogue (0 ... 10V)	1 (1/-)	--	--	-
Relay	8 (3 / 8)	4 (- / 4)	--	-
Auxiliary voltage	1 (5V DC)	--	--	-
Interfaces				
RS 232	x	x	x	x
CAN bus	x	x (- / x)	x (x / x)	x
Profibus	--	x	--	-
Voltage supply (10 ... 30V DC)	5A (10A)	5A	5A	10A

1) Always max. number of inputs and outputs, figures in brackets apply to basic modules and expansion modules

Software function packs (examples):

- Position measurement
- CAN bus communication
- Position and volumetric flow control
- Fault detection
- Controller for closed control circuits
- Ganging
- Electronic volumetric flow distribution
- Stability
- Limit load control
- Pressure control

Furthermore, the system allows customers to use the aforementioned PLC programming to very quickly make individual adaptations using structured texts (ST).

Dimensions

PLVC 41

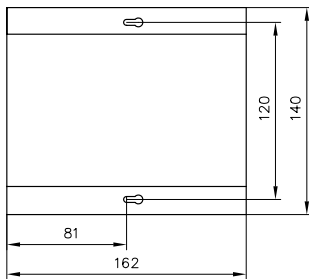
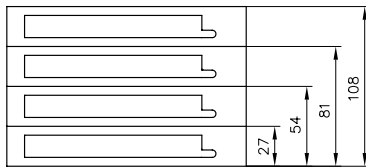

PLVC 21

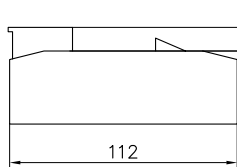

PLVC 8

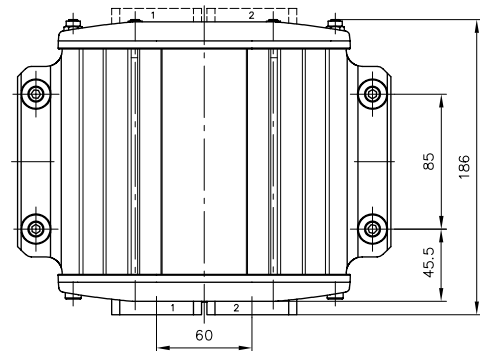
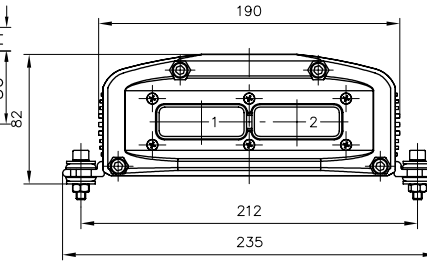

CAN-IO 14

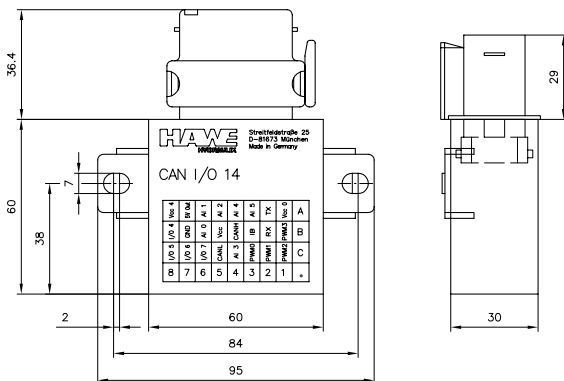

Programmable logic valve control:

- Type PLVC 21: [D 7845-21](#)
- Type PLVC 41: [D 7845-41](#)
- Type PLVC 8: [D 7845 M](#)
- Type CAN-IO 14: [D 7845 IO](#)
- Type PM, PMZ: [D 7625](#)
- Type PMV, PDV: [D 7485/1](#), [D 7486](#)
- Type PDM: [D 7486](#), [D 7584/1](#)

Prop. pressure valve:

- Including type HMT lifting modules: [Sk 7758 HMT](#)
- Type PSL, PSV prop. directional spool valves: [D 7700-2](#), [D 7700-3](#), [D 7700-5](#)
- Type SE, SEH prop. flow control valves: [D 7557/1](#)